

THANK YOU

Thank you for purchasing Marsee Products! There is a lot of competition in the marketplace and we feel you've made a wise choice by selecting Marsee. Rex Marsee started designing motorcycle apparel and luggage in 1976, the same year he made the first magnetic tank bag. Over the years Rex has been an innovator with function, quality and reasonable pricing always in the fore front.

Many of our products originate or are enhanced by customer ideas. If you have suggestions and/or ideas that may be constructive to our effort we would appreciate hearing from you.

This booklet contains important information about luggage mounting and safety. Please read this booklet and its recommended guidelines prior to using luggage

WARNING!

This manual is provided to assure proper usage of Marsee tankbags and luggage. Luggage should be sealed upon purchase to be assured it contains all mounting hardware and owner's manual. If something appears to be missing contact us immediately. Read this manual thoroughly before using your luggage. Follow all warnings, maximum load weights and mounting instruction to assure proper use of your luggage.

Never use luggage if it interferes with operation of motorcycle, view of instruments or impedes the rider in any way. Make sure luggage is properly attached for each use before operating motorcycle. Improper mounting or use can result in injury or death. Do not use luggage if it does not properly fit you or your motorcycle. Since there are many different bikes and mounting solutions this booklet is meant as a general users/mounting guide and you should make sure the luggage fits your particular vehicle before operating it. Contact us if you have any questions or problems.

MARSEE PRODUCTS WARRANTY POLICY

All Marsee products have a limited one-year warranty against defects in materials and workmanship to the original owner.

We want you to be happy with your Marsee purchase! If there is any problem with the product, we will do our best to satisfy you. We will replace your product free of charge if there is a defect in material or workmanship that shows up in the first year you use the product. Wear and tear resulting from normal usage is to be expected and does not qualify for warranty replacement. Zippers that are clearly defective will be covered under warranty, but broken zippers from normal usage are not covered.

This warranty applies only to the original purchaser and only to products purchased from an authorized Marsee dealer. If you need to return your product for warranty, please call us at 1-800-397-7815 or e-mail marsee@marseeproducts.com to obtain a Return Merchandise Authorization (RMA) Number. Unauthorized returns will be refused or returned to the customer. After obtaining an RMA, return the cleaned product (un-cleaned products will not be warranted), along with proof of purchase and your RMA number, prepaid to the manufacturer.

DANGER!

Do not attach luggage to any moving part or any part under continual high vibration. A partial list is as follows: Turn signals that are not rigidly mounted, forks, shock absorbers, swing arms, engine, chain, drive shaft, and hoses. Make sure product is adequately secured in proper location on the motorcycle before riding. Do not purchase or use the product if it cannot be properly mounted on the vehicle to be used on. Do not modify the bag in anyway to make it fit your desired application.

Do not place Marsee products close to hot metal such as exhaust or any other hot parts, as they are not fire proof or heat resistant. Nylon products such as our bags can melt and can catch on fire and can cause damage to body and equipment if exposed to heat.

Do not exceed maximum weight allowance per bag as shown below.

A bag up to 11-liter capacity maximum load is 3 pounds. A bag up to 20-liter capacity maximum load is 5 pounds.
A bag up to 30-liter capacity maximum load is 8 pounds. A bag up to 45-liter capacity maximum load is 12 pounds.
A bag up to 55-liter capacity maximum load is 18 pounds.



LOADING LUGGAGE

In order to minimize the effects of the bag's weight on the bikes center of gravity (CG) the heavier items should be placed in the bottom of the bag. Items that may be used more frequently should also be placed close to the top or in a convenient side pocket. Each rider will develop a packing order most suitable to his or her style and needs. Despite the protection provided by the bag construction and rain covers, especially valuable or delicate items are best placed in plastic zip lock bags and/or Marsee Dry Bags. Sharp or pointed objects should not be placed in bags for obvious safety reasons.

DANGER!



Do not attempt to use luggage if it cannot be properly mounted to vehicle. In the case of luggage worn on the body (i.e. waist packs, day packs, courier bags, etc.) do not use if product does not fit your anatomy properly, or if it may impede your ability to control a motorcycle.

WARNING!



Magnetic tank bags used on motorcycles have improved immensely over the years, however they are still a subject of concern. Marsee steel caps all magnets to direct magnetic energy down toward the tank, and we shield bag contents with layers of fabric and foam, so the interior is relatively safe for magnetically erasable items. Do not sit the bottom part of the magnetic tank bag on top of or in close proximity to magnetically erasable products, as it may cause an adverse effect. Further, magnets can affect the paint on some motorcycles causing a dulling effect on the paint, or creating circular patterns on the paint identical to the size of the magnets. In many cases the dullness and the rings can be buffed out, also sunlight or a mild heat lamp may help remove the problem. Marsee does not warranty against such phenomena.

CAUTION!



Modern motorcycles are fragile and expensive so use caution when mounting and dismounting motorcycle luggage hardware. While there is little or no metal on a Marsee piece of luggage, improperly handled hardware can cause damage to a motorcycle and Marsee cannot be responsible for such causes.

**CAUTION**

In the case of expandable tank bags, as they are loaded, they become taller and can interfere with an unobstructed view of gauges, warning lights, instruments, and the front wheel. An over loaded tank bag can cause interference with the horn, turn signals, and starter, especially at full steering lock. If the rider's thumb comes into contact with the bag at full lock, operation of the front brake or clutch may be compromised. Once the tank bag is loaded, the bike should be checked for any possible interference with steering or controls. Do not ride the motorcycle with the tank bag mounted on the bike if the problem can't be resolved.

Rear mounted bags should be checked for any possible interference with the rear wheel, swing arm, drive shaft, shock absorbers or any other moving part. Do not ride the bike until the problem is resolved. Play it safe and don't overload luggage, adhere to the maximum weights recommended for the luggage. Please take all precaution in mounting and loading luggage safely. Improperly mounted or overloaded bags can prove to be a safety hazard. If you have doubts don't use the product. You may call us with concerns or questions at 800-397-7815 or 317-639-0725 and we'll try to help.

MAINTENANCE AND REPAIR

The luggage itself does not require any real maintenance and should last a lifetime of riding, with the exception of normal wear and tear, and the damage caused by nature. Try to keep the luggage out of the sun as much as possible, and keep the luggage clean. Attaching hardware and straps repeatedly can cause excessive wear on them. Marsee is not responsible for damage caused by accidents.

CLEANING AND CARE

To clean luggage use a mild detergent and warm water on the exterior if needed. The reflective material should be gently washed with a soft cloth, as it does not tolerate abrasion. Wash the interior as little as possible as it could erode the layer of interior waterproofing. Let bag drip dry.

TANK BAG MOUNTING SYSTEMS

Because there are literally hundreds of applications for our tank bags we cannot show specific set-ups for each bike, so we show a basic set-up. This is meant only to be a guide and you should make sure the luggage fits your particular bike before operating it. Straps and mounting should never interfere with steering or handling of motorcycle not interfere with rider controls or instruments. If you have trouble mounting a TANK BAG please contact us and we'll try to assist.



WARNING!

Follow weight load maximums for the liter size bag (see page 2).
Do not attach straps to anything that may impede steering capabilities.
Do not mount quick release or safety lanyard as illustrated in figure 1.



4-POINT QUICK RELEASE MOUNTING GUIDELINES

1. Front straps - make sure straps go between steering head and tank or call for appropriate instructions. Straps should never interfere with steering.
2. Straps at seat - straps go between tank and seat. Make sure straps are adequately anchored. Many times the position of the TANK BAG can be adjusted along the length of the tank to comfortably position TANK BAG closer or further away from rider seating position. Adjust straps from front to back accordingly. Use harness to stabilize straps.



MAGNETIC TANK BAG MOUNTING GUIDELINES

CAUTION! Magnets in our tank bags are very strong. Consequently these magnets may adversely affect articles you place near them such as cassette tapes, bank cards, PDAs, electronic devices, floppy disks, etc.

Always inspect bottom of bag and tank before placing on bike to insure it is free of debris or objects that may have attached to magnets. It is advised to keep away from sand. Gently set bag on tank while mounting.



SAFETY LANYARD MOUNTING

ATTENTION! Our magnetic tankbags are equipped with a quick release safety lanyard which must be attached securely to the motorcycle and the magnetic bag when in use on the motorcycle.

DO NOT let impede steering

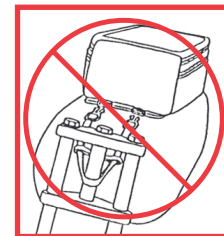
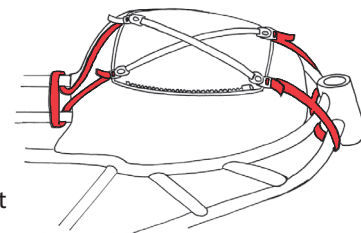
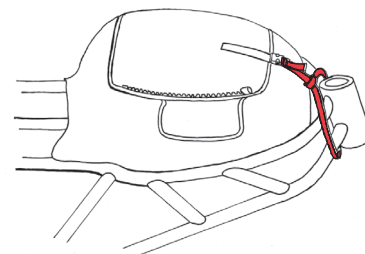

Figure 1



Quick Release Tankbag



Magnetic Tankbag w/ lanyard

4 POINT MONO BUCKLE MOUNTING GUIDELINES

To mount tank bag on bike, place the base on tank in desired location. Loop the mounting straps around frame tube in desired location and snap the male portion of the mono buckle into the female portion of buckle on base. Please note there are fleece tubes included in strap system. Pull the straps through these tubes to protect the paint on the tank. Note there are Retention Straps for the two front straps and the two rear straps. These straps hold the straps on the bike if the base is disconnected from the bike. Once all four straps are in place tighten the straps down securely. Zip the tank bag in place and before riding make sure straps are not attached to any moving object or in close proximity to anything that could create a hazard while riding.

Mono buckle mounting system is designed to be used mostly on trellis frames but can work on other frames using second set of straps included with tank bag. (See 4-point mounting system on page 5).

Mono buckles have approximately 90 degrees of rotation so tank bag can also be mounted as a seat bag by wrapping the straps under the seat and back up to the mono buckle mounts on tank bag base.

Please note, the back side mirror image of side shown.

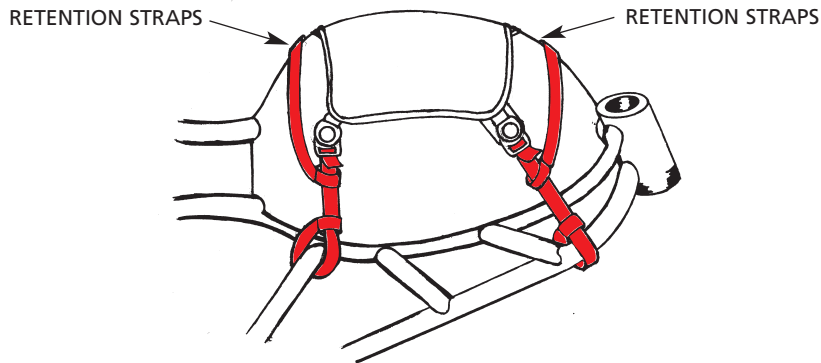

1.5 LITER BULLET BAG - MAG TO PLASTIC MOUNT

How to install magnets on the underside of plastic components of a motorcycle

- A. Use the template enclosed with kit to locate where the magnets are to be mounted.
- B. Using the template draw a circle on the plastic where the cutout circles on the template are.
- C. Apply a small amount of the Super Glue (included in the tank bag) on the thick part of each magnet and place in the position where the circles are. Hold the magnets firmly in place for 30 seconds, they should stay attached. If the magnets do not stay in place check the surface for irregularities or for small particles that could prevent cohesion. Correct the problem and re-glue again. If unsuccessful call Marsee Customer Service for help.
- D. Once the magnets are successfully glued in place leave the glue cure for 12 hours before attempting to use the tank bag.
- E. Prior to mounting the tank bag, make sure both surfaces, the bottom of the tank bag and the plastic part it is to sit on, are clean.



CAUTION

- A. Each time the bag is used make sure magnets on the underside of the plastic are still mounted firmly in place. Do not use the tank bag if they are not.
- B. Always make sure the surface where the tank bag is to be mounted and the tank bottom are clean.
- C. Do not sit the tank bag on top of any item that is adversely affected by magnets. Do not place any item inside the tank bag that could be adversely affected by magnets.
- D. Do not use the tank bag until you have read and understand the "Owner's Manual".
- E. Do not place more than 1.5 pounds of cargo inside the tank bag.
- F. It is possible for tank bags to "jar loose" from the motorcycle and fall off causing an accident resulting in injury or death. If you feel at risk with this product, DO NOT USE IT!

THE CORONA SYSTEM CONSISTS OF THREE COMPONENTS

1. The tank bag.
2. The top Corona that is mounted to the tank bag.
3. The bottom Coronas that mounts to the fuel cap filler outer ring.

FUEL CAP RING MOUNTING INSTRUCTIONS

Installing the Corona system is quite simple.

1. Remove the fuel cap screws that will be replaced by the screws enclosed that will attach the bottom Corona ring to the fuel cap ring.
2. Lay the bottom Corona ring on the fuel cap ring.
3. Apply Locktite Blue to the screws as you install them into the fuel cap ring. Finger tighten each screw as they are being installed. After all the screws are in place cross tighten each screw with a torque wrench to 38 to 40 inch pounds. We have yet to establish a torque value on the two small forward mounted screws on the Honda and Ducati bottom Corona. On those screws we suggest you apply Locktite Blue and tighten them until they are snug.

MOUNTING THE TANK BAG ON THE BOTTOM CORONA

1. Place the tank bag on top of the bottom Corona at about 10:00. Make sure the top Corona has nested into the bottom Corona, twist the tank bag clockwise to 12:00, the bag should "click" firmly in place.



ATTACH THE SECURITY STRAP

1. The security strap has a hook at one end and a loop at the opposite end. The strap is also adjustable.
2. Take the strap and wrap it around the steering head, or some other convenient location that will not impede steering or will not create a hazard. This is accomplished by running the snap hook end through the loop end after the straps has been wrapped around the desired object.
3. Snap the hook to the D ring on the back center of the tank bag.
4. Tighten the strap to a point where it is tight but will not impede steering or create a safety hazard. Tuck the excess strap out of the way so it does not become a safety hazard.

Finally double check all the steps to make sure installation is correct, if so you're ready to ride!

CAUTION:

1. The Corona tank bag system is not designed for off-road riding. Do not ride off-road while the Corona tank bag is mounted on the bike.
2. Always wear a helmet and other safety gear.
3. Never take drugs or drink alcohol and ride.
4. All the instructions in the world won't help if you don't follow them and use good common sense!



CRUISER BAR BAG MOUNTING

1. Raise the sissy bar pad
2. If necessary to fit the width of the sissy bar (back rest) unzip expandable section and pull the stretch panel, down over the sissy bar (back rest) until it touches the sissy bar pad.
3. Run the sissy bar straps under the sissy bar, run the strap through loop and attach the male part of the buckle to the female part of the buckle. Pull loose end of strap down until the sissy bar pad is firmly tightened in place.
4. Pull the straps down from under the side pockets. There are two ways to mount the straps to the motorcycle;
 - a. Undo the quick release buckles and pass them under a mounting bar on the side of the motorcycle (locations and types will vary) bring the strap back up the other side and reconnect the male part of the buckle to the female part. Then pull the loose end of the straps down until the bag is firmly in place. Do this to both sides of the bag. When finished make sure the bag is evenly mounted and secured tightly.
 - b. Place the J hooks under a frame tube, metal fender, etc. then using loose end of strap tighten the strap until J hook is firmly in place. Tighten all four J hooks equally and make sure the load is equally balanced.

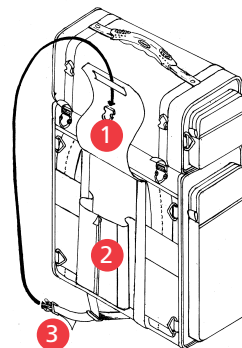



WARNING!

Maximum cargo capacity is 12 pounds, make sure load is balanced. Make sure straps are secure and are not attached to any moving part and cannot come in contact with any moving part. Prior to each use of the bike make sure the bag is properly and securely in place.

CONVERTING THE CRUISER BAR BAG TO A BACK PACK

1. Pull the shoulder straps from the elastic strap storage compartment
2. Connect the ends of the shoulder straps to the D rings on the side of the bag.
3. Connect the female portion of the quick release buckles of the compression straps to the male buckles (4) on the roll bag.

After passing the arms through the shoulder straps and standing erect, first take the loose ends of the shoulder straps and tighten them until pack is in a comfortable position. Secondly take the loose ends of the compression straps and pull on them until the roll bag feels comfortably forward. After walking a short distance it may be necessary to readjust straps to secure correct balance and comfort level.

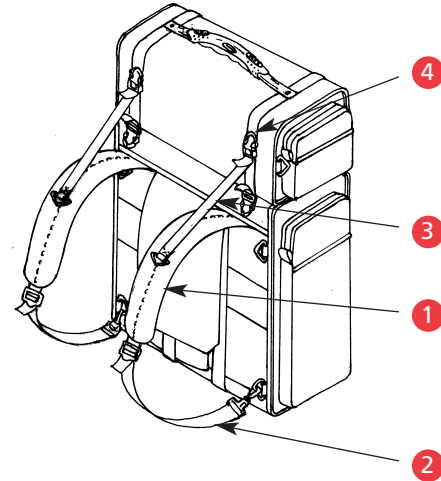

20 LITER REAR BAG MOUNTING

There are 3 basic ways to mount the 20 Liter Rear Bag.

1. On all four corners of the bag there are vertical "hook and loop" straps. These "hook and loop" straps are used when mounting the bag to a rack. Raise the top layered strap so the middle layer strap is free to be laced through the rack bar. Pull the middle layer strap back up to the "hook and loop" strip attached to the side wall of the bag and firmly attach. Next place the top layer strap on top of the middle layer strap. Repeat on all four corners of the bag. When complete the bag should be tightly and securely in place.
2. Located under both side pockets are straps that drop down. Disconnect the buckles and pull the strap under the side rail tubes and reconnect the buckles. Do this on all four straps (two on each side of the bag) When complete pull on the loose end of the strap until all four straps are snug and the bag is secure.
3. Located under both side pockets are straps that pull down. On each strap is a J hook. Hook the J hook to a metal fender or frame tube and tighten in place by pulling on the loose end of the drop down straps. When complete all four straps should be tight and equally snug on all four corners.



WARNING!

Make sure all loose ends of straps are away from any moving part. Do not attach straps to a moving part or close to a moving part. Check the bag prior to riding to make sure the bag is properly secured and is safely mounted.

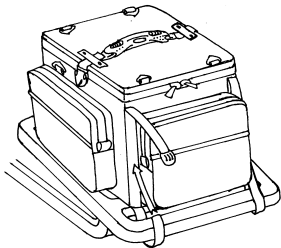

1

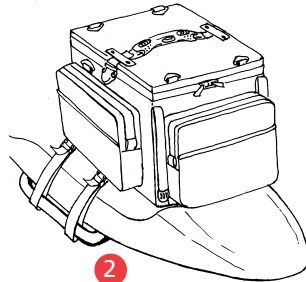

2

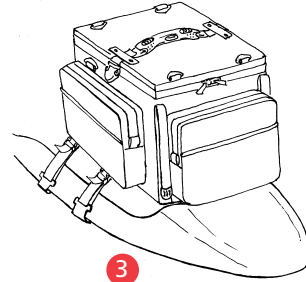

3